

KM SERIES FITTING FOR CM10 (DDK Ltd.)

MAIN MATERIAL	SURFACE FINISH	FEATURE	ENVIRONMENT	TEMPERATURE RANGE
ZDC2	Electroplated zinc	IP67	RoHS	Lowest -20 °C ~Highest 90°C

FOR DDK LTD. PRODUCT

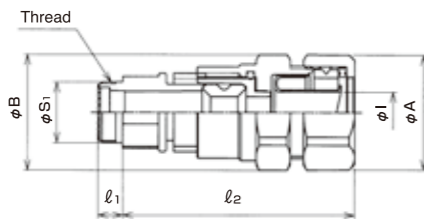
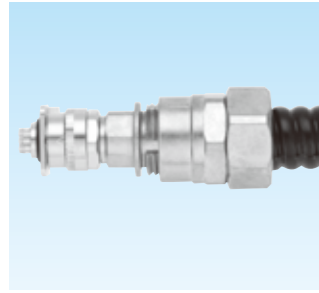

- Straight connector
- Designed to connect KEIFLEX to Connector of DDK Ltd.
- ※1 (in the column of "Connectable KEIFLEX" in the chart) denotes KMS, KMV, KPF, KIC, KIH, KIV, KPBF, KUU, KCS
- ※2 (in the column of "Connectable connector" in the chart) denotes CM10-SP(DDK Ltd.). (Note: Backshell shall be disconnected when connecting)
- CM10-SP-CV (DDK Ltd.) can be connected
- Refer to an installation instruction of N2HOM※※-MD25

Delivery	Item number	Connectable		Cable outside diameter to be inserted		φA	φB	φI	l1	l2	Thread JIS B 0207		Weight (g/pc)	Qty / Package	
		KEIFLEX	Connector	Max.	Min.						φS1	Nominal size			
③	KMHOM1208-MD26	※1	12	※2	8	4	30.4	30.4	10.8	6.5	62	15.9	M16×1	99	10
③	KMHOM1210-MD26	※1	12	※2	10	8	30.4	30.4	10.8	6.5	62	15.9	M16×1	112	10
③	KMHOM1608-MD26	※1	16	※2	8	4	34.2	32.0	14.3	6.5	62	15.9	M16×1	103	10
③	KMHOM1612-MD26	※1	16	※2	12	8	34.2	32.0	14.3	6.5	61	15.9	M16×1	116	10

KM SERIES COUPLING FOR JN1※W/JN2※W (Japan Aviation Electronics Industry Limited)

MAIN MATERIAL	COLOR	FEATURE	FEATURE	ENVIRONMENT	ENVIRONMENT	FLAMMABILITY	TEMPERATURE RANGE
PA66	Black	IP67	Oil resistance	HALOGEN FREE	RoHS	UL94V2	Lowest -20 °C ~Highest 90°C

FOR JAE PRODUCT

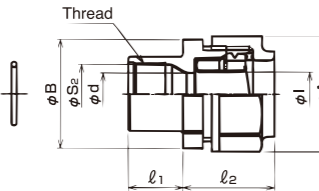

- Non-metallic coupling
- Designed to connect KEIFLEX to Connector of Japan Aviation Electronics Industry, Limited
- Refer to an installation instruction of N2KY20-SP491
- ※1 (in the column of "Connectable KEIFLEX" in the chart) denotes KMS, KMV, KPF, KIC, KIH, KIV, KPBF, KUU, KCS
- ※2 (in the column of "Connectable connector" in the chart) denotes JN1※W/JN2※W (Japan Aviation Electronics Industry, Limited)

Delivery	Item number	Connectable		Cable max outside diameter to be inserted	φA	φB	φd	φI	l1	After box nut gets fully tightened l2	Connectable thread		Weight (g/pc)	Qty / Package	
		KEIFLEX	Connector								φS2	Nominal size			
◎	KMKYP16-SP492	※1	16	※2	φ 12	37.5	35.3	13.6	14.3	17.7	27	19.2	M20×2.0 (double-start thread)	26	10

KM SERIES FITTING FOR SERVO MOTOR (αi,βi - Fanuc Corporation)

FEATURE	TEMPERATURE RANGE
IP67	Lowest -20 °C ~Highest 90°C

FOR JAE PRODUCT

NON-METALLIC

MAIN MATERIAL	COLOR	FEATURE	ENVIRONMENT	ENVIRONMENT	FLAMMABILITY
PA66	Black	Oil resistance	HALOGEN FREE	RoHS	UL94VO

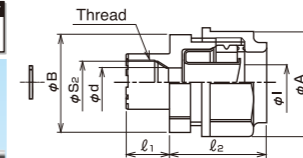

- Non-metallic coupling
- Designed to connect KEIFLEX to Connector of Japan Aviation Electronics Industry, Limited
- Refer to an installation instruction of N2KY※※FN3
- ※1 (in the column of "Connectable KEIFLEX" in the chart) denotes KMS, KMV, KPF, KIC, KIH, KIV, KPBF, KUU, KCS
- ※2 (in the column of "Connectable connector" in the chart) denotes JN1 SERIES, JN2 SERIES (Japan Aviation Electronics Industry, Limited)
- Available on request : Reinforcement (stay) SFPA437 ~ 441: designed for connectors of Japan Aviation Electronics Industry, Limited (Refer to the page for SANFLEKI ROBO)

Delivery	Item number	Connectable		Cable max outside diameter to be inserted	φA	φB	φd	φI	l1	After box nut gets fully tightened l2	Connectable thread		Weight (g/pc)	Qty / Package	
		KEIFLEX	Connector								φS2	Nominal size			
◎	KMKYP12-FN5	※1	12	※2	8.3	33.2	31.1	8.4	10.8	13.6	27	12.2	M13×1.0 (double-start thread)	20	5

BRASS

MAIN MATERIAL
Brass

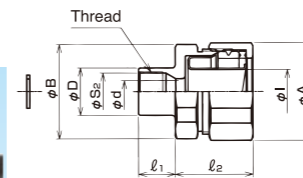
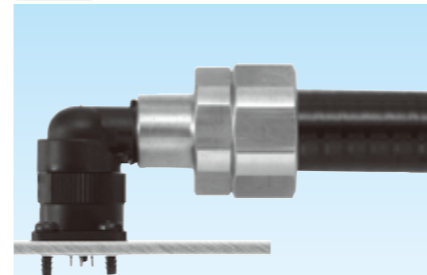

- Coupling
- Designed to connect KEIFLEX to Connector of Japan Aviation Electronics Industry, Limited
- Refer to an installation instruction of N2KY※※FN3
- ※1 (in the column of "Connectable KEIFLEX" in the chart) denotes KMS, KMV, KPF, KIC, KIH, KIV, KPBF, KUU, KCS
- ※2 (in the column of "Connectable connector" in the chart) denotes JN1 SERIES, JN2 SERIES (Japan Aviation Electronics Industry, Limited)

Delivery	Item number	Connectable		Cable max outside diameter to be inserted	φA	φB	φd	φI	l1	After box nut gets fully tightened l2	Connectable thread		Weight (g/pc)	Qty / Package	
		KEIFLEX	Connector								φS2	Nominal size			
◎	KMKY10-FN10	※1	10	※2	8.3	25.5	24.4	8.5	8.5	12	20	12.2	M13×1.0 (double-start thread)	49	5
◎	KMKY12-FN10	※1	12	※2	8.3	28.7	27.6	8.5	10.8	12	22	12.2	M13×1.0 (double-start thread)	64	5
◎	KMKY16-FN10	※1	16	※2	8.3	31.9	30.8	8.5	14.3	12	22	12.2	M13×1.0 (double-start thread)	72	5

FOR Tyco Electronics AMP K.K PRODUCT

ZINC ALLOY DIE CASTING

MAIN MATERIAL	SURFACE FINISH	ENVIRONMENT
Brass	Electroplated zinc	RoHS

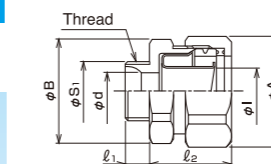

- Connector
- Designed to connect KEIFLEX to Connector of Tyco Electronics AMP K.K
- Refer to an installation instruction of N2BM20FN4

- ※1 (in the column of "Connectable KEIFLEX" in the chart) denotes KMS, KMV, KPF, KIC, KIH, KIV, KPBF, KUU, KCS
- ※2 (in the column of "Connectable connector" in the chart) denotes 1473393-1, 1473393-2 (Tyco Electronics AMP K.K)

Delivery	Item number	Connectable		Cable max outside diameter to be inserted	φA	φB	φd	φI	l1	After box nut gets fully tightened l2	Connectable thread JIS B 0207		Weight (g/pc)	Qty / Package	
		KEIFLEX	Connector								φS2	Nominal size			
◎	KMBM16-FN6	※1	16	※2	11.4	34.2	32	11.5	14.3	7.5	22	18	M18×1.5	63	20

KM SERIES FITTING FOR SMALLER OUTSIDE DIA KEIFLEX

MAIN MATERIAL	SURFACE FINISH	FEATURE	ENVIRONMENT	TEMPERATURE RANGE
ZDC2	Electroplated zinc	IP67	RoHS	Lowest - 20 °C ~Highest 90°C

FOR SMALLER OUTSIDE DIA KEIFLEX

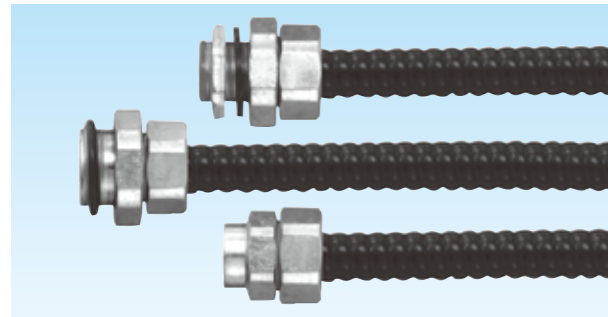

- Fitting for KEIFLEX with outside diameter 9mm or smaller
- Connectable KEIFLEX: Refer to the page of SMALLER OUTSIDE DIA KEIFLEX

KM SERIES FITTING FOR KNOCKOUT

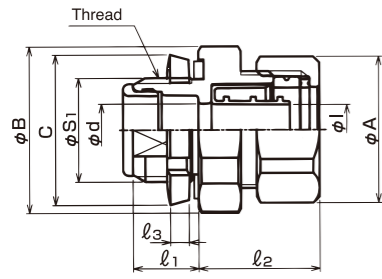

[METRIC THREAD - EXTERNAL THREAD]

Deliv-ery	Item number	Connctable KEIFLEX	Cable max outside diameter to be inserted	φA	φB	C	φd	φl	l1	After box nut gets fully tight-ened l2	l3	Thread JIS C 8463		Weight (g/pc)	Qty / Package
												φS1	Nominal size		
⊙	KMBM0916	KMS 9	7	22.4	25.5	23	8.0	7.7	10.0	17	3.0	15.9	M16X1.5	35	20

KM SERIES FITTING FOR ELECTRIC DEVICES

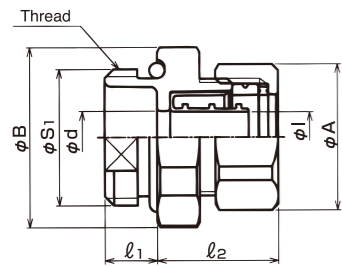

[PARALLEL PIPE THREAD - EXTERNAL THREAD]

Deliv-ery	Item number	Connctable KEIFLEX	Cable max outside diameter to be inserted	φA	φB	φd	φl	l1	After box nut gets fully tight-ened l2	l3	Thread JIS B 0202		Weight (g/pc)	Qty / Package
											φS1	Nominal size		
⊙	KMOG09	KMS 9	7	22.4	27.6	8.0	7.7	8.0	17	20.9	G1/2	34	20	

KM SERIES COUPLING

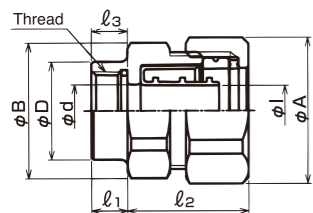

[CONNECTED TO EXTERNAL THREAD - METRIC THREAD]

Deliv-ery	Item number	Connectable		Cable max outside diameter to be inserted	φA	φB	φd	φl	φD	l1	After box nut gets fully tight-ened l2	l3	Weight (g/pc)	Qty / Package
		KEIFLEX	External thread JIS B 0207											
⊙	KMKY0912-SP302	KMS 9	M12X1	7	22.4	20.8	8.0	7.7	15.0	5.5	17	5.5	22	10

MAIN MATERIAL	COLOR	ENVIRONMENT	FLAMMABILITY	TEMPERATURE RANGE
PA6	Black	RoHS	UL94VO	Lowest - 20 °C ~Highest 100°C

BUSHING

NON-METALLIC BUSHING FOR END OF KEIFLEX

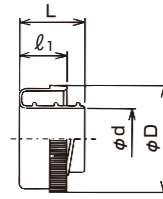

- Non-metallic Bushing for conduit
- Designed for SMALLER OUTSIDE DIA KEIFLEX

[FOR KEIFLEX KM / KI]

Deliv-ery	Item number	Connctable KEIFLEX	φD	φd	L	l1	Weight (g/pc)	Qty / Package	
⊙	KBI 5	KM KI	5	9.6	3.9	11.5	8.5	0.2	10
⊙	KBI 6		6	10.6	4.9	11.5	8.5	0.2	10
⊙	KBI 7		7	11.9	5.7	13.0	10.0	0.5	10
⊙	KBI 8		8	12.9	6.7	13.0	10.0	0.5	10
⊙	KBI 9		9	13.9	7.7	13.0	10.0	0.6	10

[FOR KEIFLEX KMS]

Deliv-ery	Item number	Connctable KEIFLEX	φD	φd	L	l1	Weight (g/pc)	Qty / Package
⊙	KFLP 09	KMS 9	13.8	7.7	12	9	0.6	100

MULTIPLE KEIFLEX CLAMPING KIT

MAIN MATERIAL	FEATURE	FEATURE	ENVIRONMENT	FLAMMABILITY	TEMPERATURE RANGE
PA6	IP54	Oil resistance	RoHS	UL94VO	Lowest - 20 °C ~Highest 90°C

Type EMS

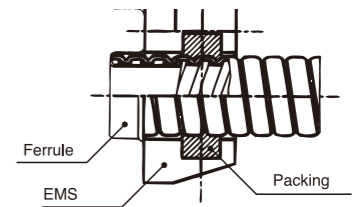
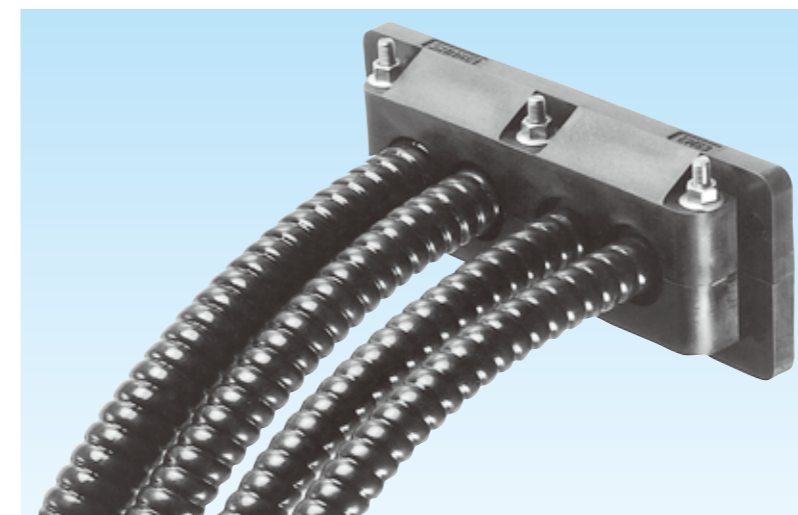

PACKING

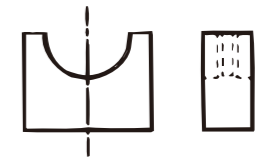

- MULTIPLE KEIFLEX CLAMPING KIT
- Designed for Wiring box
- Multiple KEIFLEX type KMS/KPF can be clamped
- Use Packing EM23P / EM28P exclusive to KEIFLEX installation for MULTIPLE KEIFLEX CLAMPING KIT
- No connectors are required for KEIFLEX installation
- Inside a wiring box: Use Ferrule (KFL) at the edge of KEIFLEX to fix

- Simple assembly method
- Possible to assemble the kit after connecting KEIFLEX to wiring boxes
- Possible to reduce workload
- Note: MULTIPLE KEIFLEX CLAMPING KIT and Packing EM23P / EM28P are separately available.
- Dimension: Refer to a page for KEIGLAND

EMS 3M FOR KEIFLEX SIZE 16 OR SMALLER SIZE

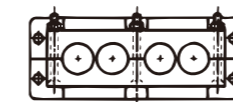

EMS3M4

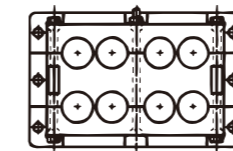

EMS3M8

EMS 6M FOR KEIFLEX SIZE 16 OR SMALLER SIZE

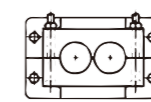

EMS6M2

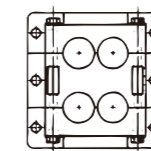

EMS6M4

EMS 8M FOR KEIFLEX SIZE 22 OR SMALLER SIZE

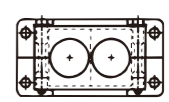

EMS8M2

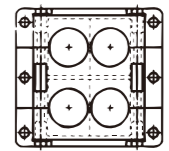

EMS8M4

Deliv-ery	Item number	Color	Suitable Packing	Set / Package
⊙	EMS3M 4	Black	EM23P	1
⊙	EMS3M 8			1
⊙	EMS3M 4 LG	1		
⊙	EMS3M 8 LG	1		
⊙	EMS3M 4 IV	1		
⊙	EMS3M 8 IV	Ivory	1	

Deliv-ery	Item number	Color	Suitable Packing	Set / Package
⊙	EMS6M 2	Black	EM23P	1
⊙	EMS6M 4			1
⊙	EMS6M 2 LG	1		
⊙	EMS6M 4 LG	1		
⊙	EMS6M 2 IV	Ivory		1
⊙	EMS6M 4 IV	Ivory	1	

Deliv-ery	Item number	Color	Suitable Packing	Set / Package
⊙	EMS8M 2	Black	EM28P	1
⊙	EMS8M 4			1
⊙	EMS8M 2 LG	1		
⊙	EMS8M 4 LG	1		
⊙	EMS8M 2 IV	Ivory		1
⊙	EMS8M 4 IV	Ivory	1	

MATERIAL	COLOR	ENVIRONMENT	TEMPERATURE RANGE
TPE	Black	RoHS	Lowest - 20 °C ~Highest 100°C

PACKING

[PACKING EM23P FOR KEIFLEX SIZE 16 OR SMALLER SIZE]

Deliv-ery	Item number	Connctable KEIFLEX	Suitable EMS	Set / Package
⊙	EM23P 0	Non-opening packing	EMS3M EMS6M	20
—	EM23P 10M	KMS 10		—
⊙	EM23P 12M	KMS 12		—
⊙	EM23P 16M	KMS 16		20
⊙	EM23P 15	KPF 10		20
⊙	EM23P 17	KPF 12		20
⊙	EM23P 21	KPF 16		20

[PACKING EM28P FOR KEIFLEX SIZE 22 OR SMALLER SIZE]

Deliv-ery	Item number	Connctable KEIFLEX	Suitable EMS	Set / Package
⊙	EM28P 0	Non-opening packing	EMS8M	5
—	EM28P 10M	KMS 10		—
⊙	EM28P 12M	KMS 12		5
⊙	EM28P 16M	KMS 16		5
⊙	EM28P 22M	KMS 22		5
⊙	EM28P 14	KPF 10		5
⊙	EM28P 16	KPF 12		5
⊙	EM28P 20	KPF 16		5
⊙	EM28P 26	KPF 22		5

Contact us for information of product availability and delivery

K SERIES FITTING

CONSTRUCTION

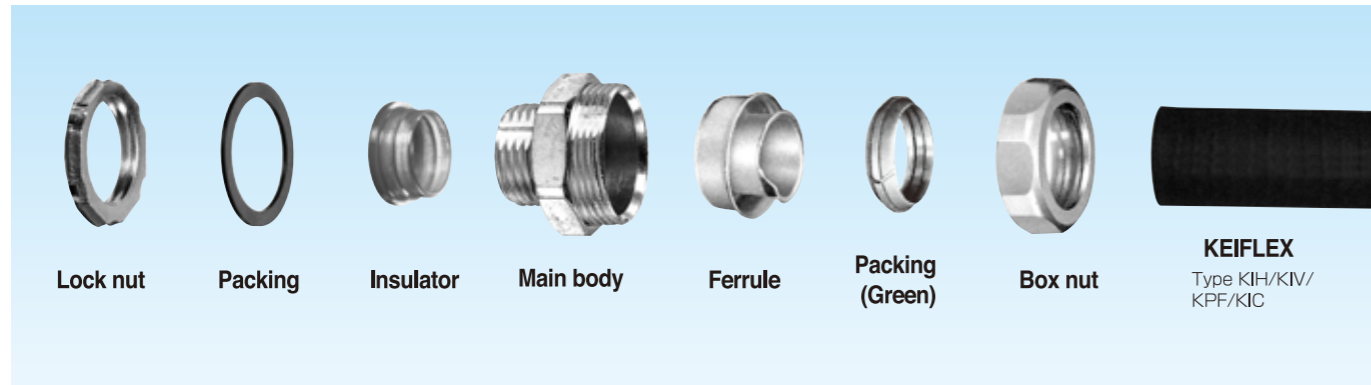

CONNECTABLE KEIFLEX

CONNECTABLE KEIFLEX	
KIH	
KIV / KPF / KIC	See NOTE a

NOTE a: K2 SERIES can be connected

APPLICATION

Mainly suitable for plant installation

THREAD

G thread or CTG thread only

INSULATOR COLOR

RED

MATERIALS

Material information is as below unless otherwise specified

PART NAME	MATERIAL	FINISH
MAIN BODY STRAIGHT	ZDC	ELECTROPLATED ZINC
90/45 DEGREE ANGLE	ZDC	ELECTROPLATED ZINC
INSULATOR	PA	—
BOX NUT	ZDC	ELECTROPLATED ZINC
FERRULE	SPCE	ELECTROPLATED ZINC
PACKING	PA	—
PACKING	NBR	—
LOCK NUT	SPHC	ELECTROPLATED ZINC

ASSEMBLY INSTRUCTION

1. Pass KEIFLEX through Box nut as the drawing shows

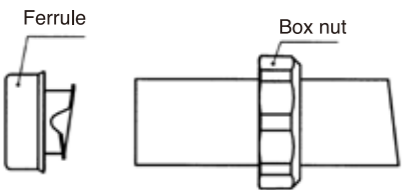

2. Screw Ferrule onto KEIFLEX completely

3. Move the packing toward the ferrule until they touch each other
 4. Combine Connector Main body with the ferrule

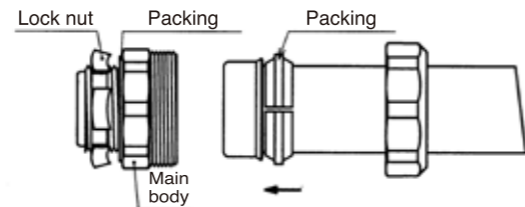

5. Connect the box nut to the Connector Main body
 6. Tighten up the box nut completely

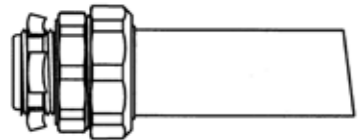

TO TIGHTEN BOX NUT

Motor wrench - Recommended tool to tighten up Hexagon box nut For fitting nominal size 16 to 42: Super tool MF280

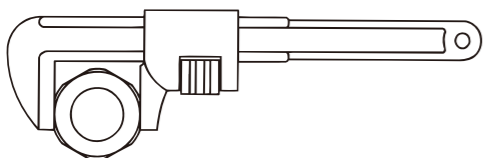

For Box nut with wrench bumps For fitting nominal size 54 or bigger: Tighten up Box nut by using two (2) monkey wrenches

Note: In order to avoid damage to Box nut, follow the instruction below: Do not tighten up Box nut only with one (1) monkey. When using two (2) monkey wrenches, they shall not be at right angles.

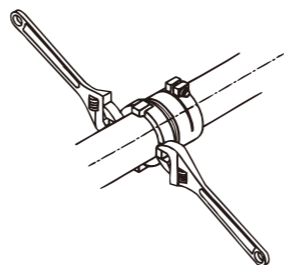

K SERIES FITTING FOR KNOCKOUT

MAIN MATERIAL	SURFACE FINISH	FEATURE	ENVIRONMENT	TEMPERATURE RANGE
ZDC2	Electroplated zinc	IP66	RoHS	Lowest - 20 °C ~Highest 90°C

PARALLEL PIPE THREAD - EXTERNAL THREAD

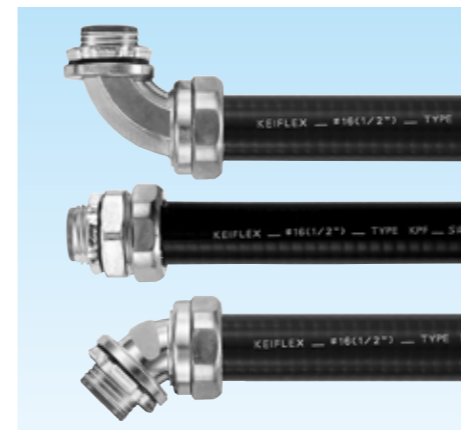

- Connector
- Style Availability: Straight / 45 degree angle-style / 90 degree angle-style
- Designed for Knockout of Wiring box
- Tensile Strength Classification between Connectable KEIFLEX and Connector
- Connector nominal size 16 to 54 : 1000N (Heavy by JIS)
- Connector nominal size 70 or bigger: 2500N (Very Heavy by JIS)
- ※ (in the column of "Connectable KEIFLEX" in the chart) denotes KPF, KIH, KIC, KIV

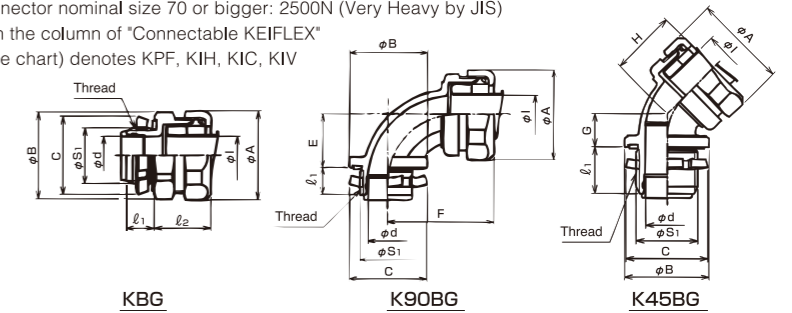

Delivery	Item number	Connctable KEIFLEX	Cable max outside diameter to be inserted	φA	φB C	φd φl	l1	l2	Thread		Weight (g/pc)	Qty / Package
									JIS B 0202	JIS C 8305		
									φS1	Nominal size		
○	KBG 16	16	13	32.9	30.8	14.1	10	18	20.9	G1/2	60	20
○	KBG 22	22	18	40.1	38.3	19.3	12	19	26.4	G3/4	85	20
○	KBG 28	28	24	48.1	47.0	24.6	14	22	33.2	G1	140	10
○	KBG 36	36	32	58.6	56.5	33.0	14	26	41.9	G1-1/4	200	10
○	KBG 42	42	37	66.3	65.3	38.2	16	29	47.8	G1-1/2	290	10
○	KBG 54	※ 54	49	84.8	80.0	49.3	16	40	59.6	G2	400	5
○	KBG 70	70	60	102.0	93.0	60.6	29	45	75.1	CTG70	1070	2
○	KBG 82	82	75	118.8	106.0	75.5	31	47	87.8	CTG82	1380	2
○	KBG 92	92	85	132.4	121.0	86.4	32	51	100.3	CTG92	1780	1
○	KBG 104	104	98	145.7	135.0	99.1	32	54	113.0	CTG104	2160	1
☒	KBG 130	130	121	186.9	168.7	122.0	34	72	138.4	G5	3150	1

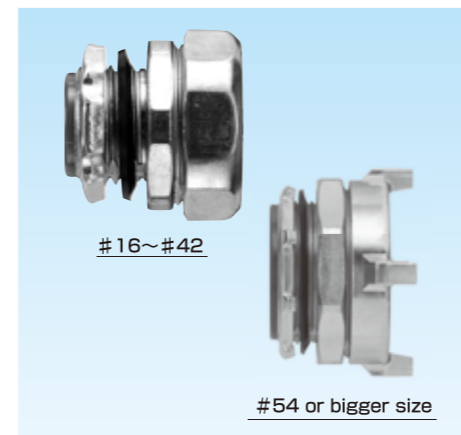

Delivery	Item number	Connctable KEIFLEX	Cable max outside diameter to be inserted	φA	φB C	φd φl	E	F	l1	Thread		Weight (g/pc)	Qty / Package
										JIS B 0202	JIS C 8305		
										φS1	Nominal size		
○	K90BG 16	16	13	32.9	29.0	14.1	19.5	33	15	20.9	G1/2	95	20
○	K90BG 22	22	18	40.1	36.0	19.3	22.2	39	15	26.4	G3/4	160	10
○	K90BG 28	28	24	48.1	44.0	24.6	28.5	45	16	33.2	G1	250	10
○	K90BG 36	36	32	58.6	53.0	33.0	31.1	54	18	41.9	G1-1/4	410	5
○	K90BG 42	42	37	66.3	61.0	38.2	40.6	61	18	47.8	G1-1/2	570	5
○	K90BG 54	※ 54	49	84.8	74.0	49.3	48.0	79	20	59.6	G2	830	5
③	K90BG 70	70	60	102.0	93.0	60.6	58.0	90	31	75.1	CTG70	1800	2
③	K90BG 82	82	72	118.8	106.0	75.5	68.0	102	33	87.8	CTG82	2650	2
③	K90BG 92	92	84	132.4	121.0	86.4	76.0	111	34	100.3	CTG92	3390	1
③	K90BG 104	104	96	145.7	135.0	99.1	83.0	119	34	113.0	CTG104	4410	1



Delivery	Item number	Connctable KEIFLEX	Cable max outside diameter to be inserted	φA	φB C	φd φl	G	H	l1	Thread		Weight (g/pc)	Qty / Package
										JIS B 0202	JIS C 8305		
										φS1	Nominal size		
○	K45BG 16	16	13	32.9	29.0	14.1	11.5	23	16	20.9	G1/2	90	20
○	K45BG 22	22	18	40.1	36.0	19.3	12.7	25	16	26.4	G3/4	130	10
○	K45BG 28	28	24	48.1	44.0	24.6	14.8	28	16	33.2	G1	240	10
○	K45BG 36	36	32	58.6	53.0	33.0	17.8	35	18	41.9	G1-1/4	330	5
○	K45BG 42	42	37	66.3	61.0	38.2	20.7	40	18	47.8	G1-1/2	490	5
○	K45BG 54	※ 54	49	84.8	74.0	49.3	24.1	54	20	59.6	G2	660	5
○	K45BG 70	70	60	102.0	93.0	60.6	23.1	67	31	75.1	CTG70	1500	2
③	K45BG 82	82	72	118.8	106.0	75.5	26.5	73	33	87.8	CTG82	2030	2
③	K45BG 92	92	85	132.4	121.0	86.4	29.8	81	34	100.3	CTG92	2580	1
③	K45BG 104	104	98	145.7	135.0	99.1	33.1	85	34	113.0	CTG104	3150	1



K SERIES COUPLING FOR RIGID STEEL CONDUIT

MAIN MATERIAL	SURFACE FINISH	FEATURE	ENVIRONMENT	TEMPERATURE RANGE
ZDC2	Electroplated zinc	Water resistance b/w Keiflex & Fitting PPS	RoHS	Lowest - 40 °C ~Highest 105°C

KEIFLEX + RIGID STEEL CONDUIT WITH THREAD

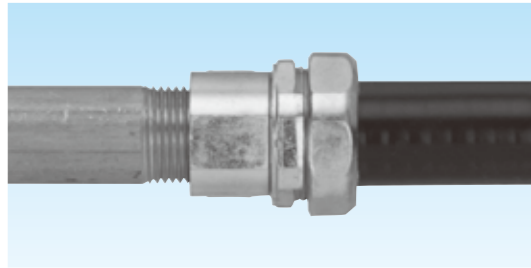

- Straight combination coupling
- Designed to connect KEIFLEX to Rigid steel conduit with thread
- Tensile Strength Classification between Connectable KEIFLEX and combination coupling
Combination coupling nominal size 16 to 54 : 1000N (Heavy by JIS)
Combination coupling nominal size 70 or bigger: 2500N (Very Heavy by JIS)
- ※ (in the column of "Connectable KEIFLEX" in the chart) denotes KPF, KIH, KIC, KIV
- GRIPLOK GWKK - Straight combination coupling, designed to connect non-thread rigid steel conduit to KEIFLEX is also available. Refer to a page for GRIPLOK for information of it.

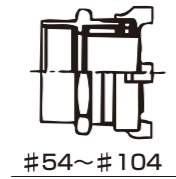

[RIGID STEEL CONDUIT WITH THREAD]

Deli-very	Item number	Connectable conduit		Cable max outside diameter to be inserted	Weight (g/pc)	Qty / Package
		KEIFLEX	RIGID STEEL CONDUIT WITH THREAD Nominal size			
○	KKG 16	16	G16 G1/2	13	55	20
○	KKG 22	22	G22 G3/4	18	85	20
○	KKG 28	28	G28 G1	24	130	10
○	KKG 36	36	G36 G1-1/4	34	190	10
○	KKG 42	42	G42 G1-1/2	37	260	10
○	KKG 54	※	54 G54 G2	49	360	5
○	KKG 70		70 G70 G2-1/2	60	1090	2
○	KKG 82		82 G82 G3	75	1400	2
○	KKG 92		92 G92 G3-1/2	85	1780	1
○	KKG 104		104 G104 G4	98	2190	1
□	KKG 130		130 G130 G5	121	3080	1

K SERIES EXPLOSION-PROOF TYPE CONNECTOR

MAIN MATERIAL	SURFACE FINISH	FEATURE	ENVIRONMENT	TEMPERATURE RANGE
ZDC2	Electroplated zinc	IP66	RoHS	Lowest -20 °C ~Highest 90°C

PARALLEL PIPE THREAD - EXTERNAL THREAD

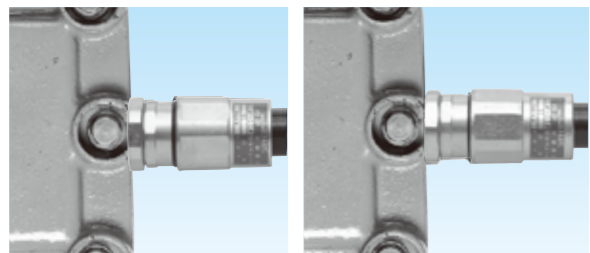

- Straight explosion-proof type connector
- Designed to connect KEIFLEX to Explosion-proof construction device
- Disconnection type KXUBG: Main body and Sleeve can be separated : A solution for efficient maintenance work
- Tensile Strength Classification between Connectable KEIFLEX and Connector Connector nominal size 12 to 54 : 1000N (Heavy by JIS)
- ※ (in the column of "Connectable KEIFLEX" in the chart) denotes KPF, KIH, KIC, KIV
- KEIFLEX KIH / KPF are recommended to use

NON-DISCONNECTION TYPE

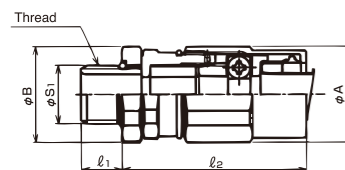

Delivery	Item number	Connectable KEIFLEX	Cable outside diameter to be inserted		φ A	φ B	l ₁	l ₂	Thread JIS B 0202		Weight (g/pc)	Qty / Package	QUALITY STANDARD Explosion-proof d2G4
			Max.	Min.					φ S ₁	Nominal size			
○	KXBG 16 12	16	12	10	34.5	34.0	15	66	20.9	G1/2	210	10	
○	KXBG 16 10		10	8							210	10	
○	KXBG 16 08		8	6							210	10	
○	KXBG 22 16	22	16	14	40.1	39.8	15	66	26.4	G3/4	270	10	
○	KXBG 22 14		14	12							270	10	
○	KXBG 22 12		12	10							270	10	
○	KXBG 22 10		10	8							270	10	
○	KXBG 28 20	28	20	18	47.9	47.8	18.5	74	33.2	G1	415	3	
○	KXBG 28 18		18	16							415	3	
○	KXBG 28 16		16	14							415	3	
○	KXBG 36 26	36	26	24	59.0	60.4	18.1	81	41.9	G1-1/4	646	2	
○	KXBG 36 24		24	22							651	2	
○	KXBG 36 22		22	20							649	2	
○	KXBG 36 20		20	18							665	2	
○	KXBG 42 30	42	30	28	66.8	68.2	18.1	88	47.8	G1-1/2	859	2	
○	KXBG 42 28		28	26							866	2	
○	KXBG 54 36	54	36	34	80.0	81.8	18.1	93	59.6	G2	1241	2	
○	KXBG 54 34		34	32							1249	2	
○	KXBG 54 32		32	30							1249	2	

MATERIAL	TEMPERATURE RANGE
CR	Lowest -20 °C ~Highest 90°C

QUALITY STANDARD
Explosion-proof d2G4

K SERIES EXPLOSION-PROOF TYPE CONNECTOR

MAIN MATERIAL	SURFACE FINISH	FEATURE	ENVIRONMENT	TEMPERATURE RANGE
ZDC2	Electroplated zinc	IP66	RoHS	Lowest -20 °C ~Highest 90°C

DISCONNECTION TYPE

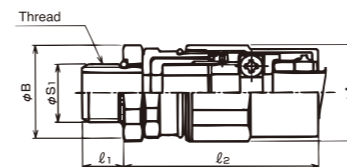

Delivery	Item number	Connectable KEIFLEX	Cable outside diameter to be inserted		φ A	φ B	l ₁	l ₂	Thread JIS B 0202		Weight (g/pc)	Qty / Package	QUALITY STANDARD Explosion-proof d2G4
			Max.	Min.					φ S ₁	Nominal size			
○	KXUBG 16 12	16	12	10	34.5	34.0	15	70	20.9	G1/2	223	10	
○	KXUBG 16 10		10	8							223	10	
○	KXUBG 16 08		8	6							223	10	
○	KXUBG 22 16	22	16	14	40.1	39.8	15	70	26.4	G3/4	282	10	
○	KXUBG 22 14		14	12							282	10	
○	KXUBG 22 12		12	10							282	10	
○	KXUBG 22 10		10	8							282	10	
○	KXUBG 28 20	28	20	18	47.9	47.8	18.5	79	33.2	G1	448	3	
○	KXUBG 28 18		18	16							448	3	
○	KXUBG 28 16		16	14							448	3	
○	KXUBG 36 26	36	26	24	59.0	60.4	18.1	86	41.9	G1-1/4	691	2	
○	KXUBG 36 24		24	22							696	2	
○	KXUBG 36 22		22	20							695	2	
○	KXUBG 36 20		20	18							700	2	
○	KXUBG 42 30	42	30	28	66.8	68.2	18.1	93	47.8	G1-1/2	914	2	
○	KXUBG 42 28		28	26							920	2	
○	KXUBG 54 36	54	36	34	80.0	81.8	18.1	99	59.6	G2	1340	2	
○	KXUBG 54 34		34	32							1352	2	
○	KXUBG 54 32		32	30							1352	2	

PACKING

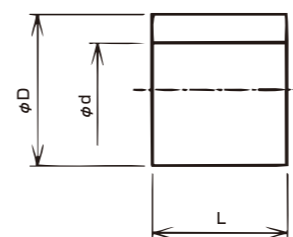
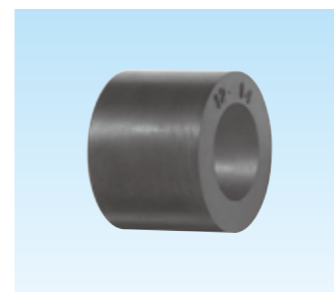

- Packing for KXBG / KXUBG
- Useful for the condition where another cable outside dia. is required.
- Note: KXBG / KXUBG and Packing KX(GP) are separately available.
- e.g. Should a cable with φ 11 mm outside dia. is required for KXBG2216, the packing of KX(GP)2212 must be used
- as the range of cable outside dia. for KXBG2216 is between φ 14 mm and φ 16 mm.

Delivery	Item number	Connectable fitting	Cable outside diameter to be inserted		φ d	φ D	L	Weight (g/pc)	Qty / Package		
			Max.	Min.							
○	KX (GP) 16 08	KXBG KXUBG	16 08	8	6	8.2	20.0	18.0	7	1	
○	KX (GP) 16 10		16 10	10	8	10.3			6	1	
○	KX (GP) 16 12		16 12	12	10	12.3			5	1	
○	KX (GP) 22 10		22 10	10	8	10.2			10	1	
○	KX (GP) 22 12		22 12	12	10	12.3	24.0	18.0	10	1	
○	KX (GP) 22 14		22 14	14	12	14.3			7	1	
○	KX (GP) 22 16		22 16	16	14	16.3	6	1			
○	KX (GP) 28 16		28 16	16	14	16.3	30.0	18.0	13	1	
○	KX (GP) 28 18		28 18	18	16	18.3			12	1	
○	KX (GP) 28 20		28 20	20	18	20.3	10	1			
○	KX (GP) 36 20		36 20	20	18	20.3	39.0	20.0	26	1	
○	KX (GP) 36 22		36 22	22	20	22.3			22	1	
○	KX (GP) 36 24	36 24	24	22	24.3	21			1		
○	KX (GP) 36 26	36 26	26	24	26.3	17			1		
○	KX (GP) 42 28	42 28	28	26	28.3	45.0	22.0	31	1		
○	KX (GP) 42 30	42 30	30	28	30.3			24	1		
○	KX (GP) 54 32	54 32	32	30	32.3	56.0	25.0	52	1		
○	KX (GP) 54 34	54 34	34	32	34.3			52	1		
○	KX (GP) 54 36	54 36	36	34	36.3			43	1		

STAINLESS EXPLOSION-PROOF TYPE FITTING

- Look at the page for SANPIPE for information of STAINLESS STEEL EXPLOSION-PROOF TYPE FITTING FOR STAINLESS STEEL KEIFLEX

KB SERIES FITTING

CONSTRUCTION

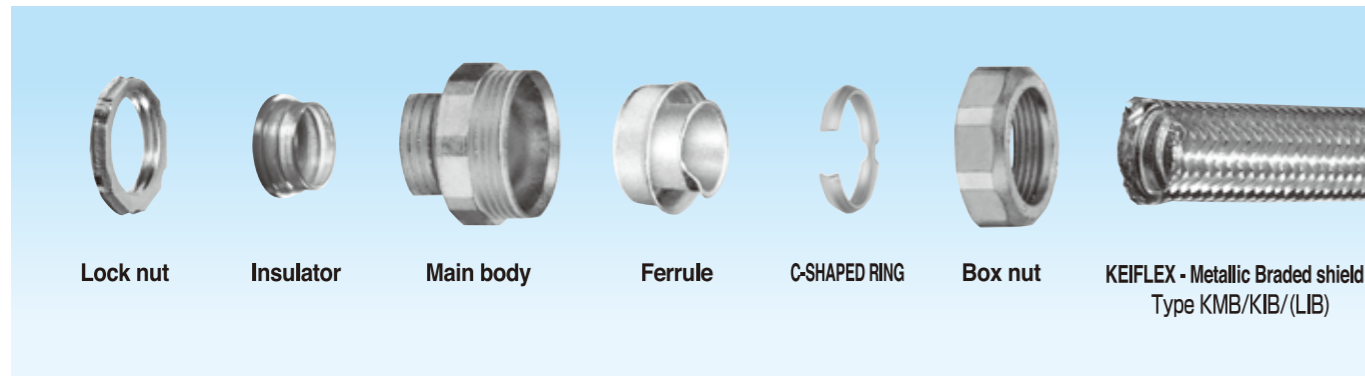

CONNECTABLE KEIFLEX

CONNECTABLE KEIFLEX	
KMB	See NOTE a
KIB	See NOTE a
LIB	See NOTE b

- NOTE a: Suitable when heat resistance/higher tensile strength are required
- NOTE b: STAINLESS FITTING KB※L SERIES is a more suitable choice

KB SERIES FEATURE

- Suitable when heat resistance/higher tensile strength are required
- Available on request: Contact us if other styles & types are required.

MATERIALS

Material information is as below unless otherwise specified

PART NAME	MATERIAL	FINISH
MAIN STRAIGHT BODY	ZDC	ELECTROPLATED ZINC
90/45 DEGREE ANGLE	ZDC	ELECTROPLATED ZINC
INSULATOR	PA	—
BOX NUT	ZDC	ELECTROPLATED ZINC
FERRULE	SPCE	ELECTROPLATED ZINC
C-SHAPED RING	SUS304	—
LOCK NUT	SPHC	ELECTROPLATED ZINC

STAINLESS STEEL

- SUS304 FITTING KB※L SERIES is also available
- Look at the page for the category of SANPIPE for more information

EARTH BONDING

- Use WASHER WITH EARTH TERMINAL (Type RWEG, RWEC) / LOCK-NUT WITH EARTH TERMINAL (RLEG, RLEC) in order to complete earth bonding in good condition when KEIFLEX KMB, KIB, KPFB, or KPBF is used.
- Refer to the page for the category of SANPARTS for more information.

WASHER WITH EARTH TERMINAL

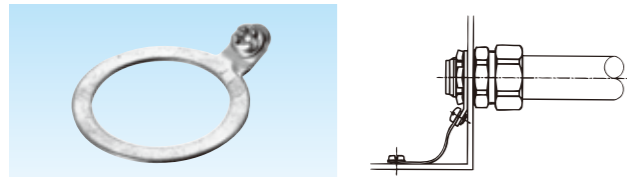

LOCK-NUT WITH EARTH TERMINAL

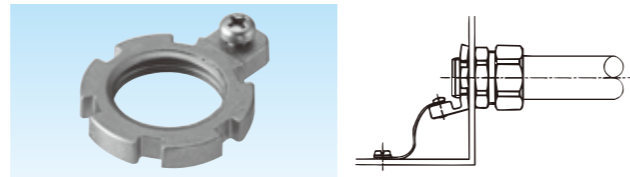

TO CUT KEIFLEX

- KEIFLEX can be cut off by using Cutting machine or Hacksaw
- A metal saw (KFTL202) for Cutting machine is available
- Take the following action in order to prevent the components of KEIFLEX type KMB/KIB from separating out
 - Fasten adhesive tape twice around an area to be cut off
 - Fasten adhesive tape tightly twice around both sides 100mm away from the area of 1)
 - Cut off the center of the area of 1).
- Remove all metal burrs and PVC burrs from the cut end of KEIFLEX by using a pair of scissors

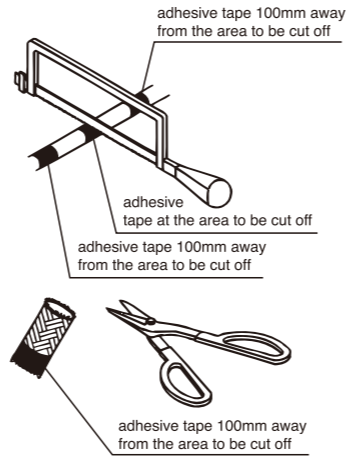

- Note: After KMB/KIB is cut off, the edge of metal conduit core and Metallic Braided shield shall have an even surface to prevent the degree of the tensile strength between a fitting and KMB/KIB from substantially decreasing. Therefore, before KMB/KIB is cut off, make sure to fasten adhesive tape tightly twice around both sides 100mm away from the area to be cut off in order to prevent metal conduit core, metallic braided shield from sliding to the wrong position.

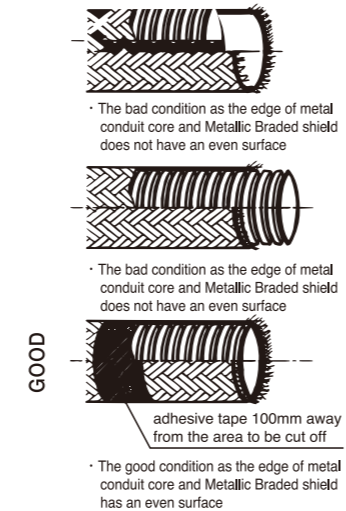

KB SERIES FITTING FOR KNOCKOUT

MAIN MATERIAL	SURFACE FINISH	FEATURE	ENVIRONMENT	TEMPERATURE RANGE
ZDC2	Electroplated zinc	Non-water resistance	RoHS	Lowest - 20 °C Highest 100°C

PARALLEL PIPE THREAD - EXTERNAL THREAD

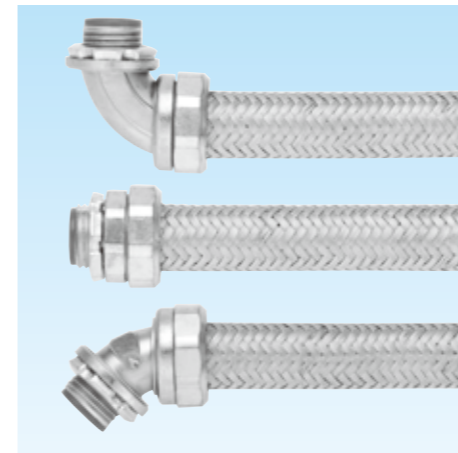

- Connector
- Connectable KEIFLEX: Refer to the chart
- Style Availability: Straight / 45 degree angle-style / 90 degree angle-style
- Designed for Knockout of Wiring box
- Tensile Strength Classification between Connectable KEIFLEX and Connector
 - Connector nominal size 10 : 500N (Medium by JIS)
 - Connector nominal size 12 to 54 : 1000N (Heavy by JIS)
 - Connector nominal size 70 or bigger: 2500N (Very Heavy by JIS)
- Note: Box nut of Connector Nominal size 70 or bigger size is in a different style

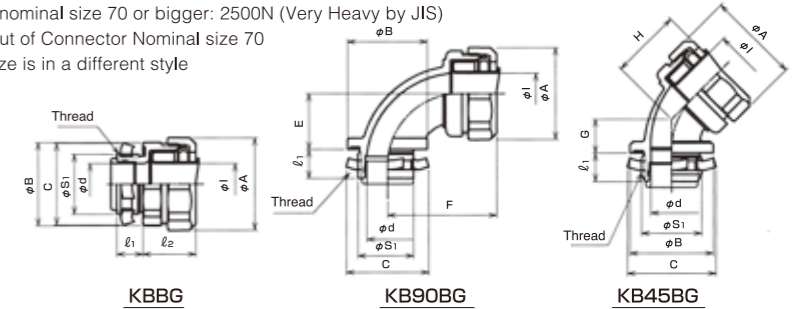

Delivery	Item number	Connectable KEIFLEX	Cable max outside diameter to be inserted	φA	φB C	φd φl	l ₁	l ₂	Thread		Weight (g/pc)	Qty / Package
									JIS B 0202	JIS C 8305		
○	KBBG 10	10	8	26.4	29.0	8.5	10.0	17	20.9	G1/2	45	20
○	KBBG 12	12	10	29.2	30.4	10.8	10.0	18	20.9	G1/2	55	20
○	KBBG 16	16	13	32.9	30.8	14.1	10.0	18	20.9	G1/2	60	20
○	KBBG 22	22	18	40.1	38.3	19.3	12.0	20	26.4	G3/4	90	20
○	KBBG 28	28	24	48.1	47.0	24.6	14.0	22	33.2	G1	140	10
○	KBBG 36	36	32	58.6	56.5	33.0	14.0	24	41.9	G1-1/4	200	10
○	KBBG 42	42	37	66.3	65.3	38.2	16.0	28	47.8	G1-1/2	290	10
○	KBBG 54	54	48	80.0	80.0	49.3	16.0	27	59.6	G2	400	5
⊠	KBBG 70	70	60	92.4	93.0	60.6	29.0	35	75.1	CTG70	1100	2
⊠	KBBG 82	82	75	109.8	106.0	75.5	31.0	40	87.8	CTG82	1430	2
—	KBBG 92	92	—	—	—	—	—	—	—	—	—	—
⊠	KBBG 104	104	98	137.5	135.0	99.1	32.0	50	113.0	CTG104	1499	1

Delivery	Item number	Connectable KEIFLEX	Cable max outside diameter to be inserted	φA	φB C	φd φl	E	F	l ₁	Thread		Weight (g/pc)	Qty / Package
										JIS B 0202	JIS C 8305		
○	KB90BG 10	10	8	26.4	29.0	8.5	16.2	30	10	20.9	G1/2	65	20
○	KB90BG 12	12	10	29.2	29.0	10.8	18.6	33	10	20.9	G1/2	65	20
○	KB90BG 16	16	13	32.9	29.0	14.1	19.5	31	10	20.9	G1/2	87	20
○	KB90BG 22	22	18	40.1	36.0	19.3	22.2	38	12	26.4	G3/4	136	10
○	KB90BG 28	28	24	48.1	44.0	24.6	25.8	43	14	33.2	G1	218	10
○	KB90BG 36	36	32	58.6	53.0	33.0	31.1	50	14	41.9	G1-1/4	312	5
○	KB90BG 42	42	37	66.3	61.0	38.2	35.6	56	16	47.8	G1-1/2	580	5
○	KB90BG 54	54	49	80.0	74.0	49.3	43.0	63	16	59.6	G2	840	2
⊠	KB90BG 70	70	60	92.4	93.0	60.6	58.0	80	31	75.1	CTG70	1080	1
⊠	KB90BG 82	82	72	109.8	106.0	75.5	68.0	94	33	87.8	CTG82	2700	1
—	KB90BG 92	92	—	—	—	—	—	—	—	—	—	—	
⊠	KB90BG 104	104	96	137.5	135.0	99.1	83.0	115	34	113.0	CTG104	4520	1

Delivery	Item number	Connectable KEIFLEX	Cable max outside diameter to be inserted	φA	φB C	φd φl	G	H	l ₁	Thread		Weight (g/pc)	Qty / Package
										JIS B 0202	JIS C 8305		
○	KB45BG 10	10	8	26.4	29.0	8.5	6.9	24	10	20.9	G1/2	70	20
○	KB45BG 12	12	10	29.2	29.0	10.8	8.6	28	10	20.9	G1/2	80	10
○	KB45BG 16	16	13	32.9	29.0	14.1	11.9	24	10	20.9	G1/2	90	20
○	KB45BG 22	22	18	40.1	36.0	19.3	12.4	26	12	26.4	G3/4	140	10
○	KB45BG 28	28	24	48.1	44.0	24.6	14.5	30	14	33.2	G1	240	10
○	KB45BG 36	36	32	58.6	53.0	33.0	18.6	35	14	41.9	G1-1/4	350	5
○	KB45BG 42	42	37	66.3	61.0	38.2	21.7	39	16	47.8	G1-1/2	490	5
○	KB45BG 54	54	49	80.0	74.0	49.3	25.0	44	16	59.6	G2	680	2
⊠	KB45BG 70	70	60	92.4	93.0	60.6	23.1	56	31	75.1	CTG70	1540	1
⊠	KB45BG 82	82	72	109.8	106.0	75.5	26.5	66	33	87.8	CTG82	2080	1
—	KB45BG 92	92	—	—	—	—	—	—	—	—	—	—	
⊠	KB45BG 104	104	98	137.5	135.0	99.1	33.1	80	34	113.0	CTG104	3260	1

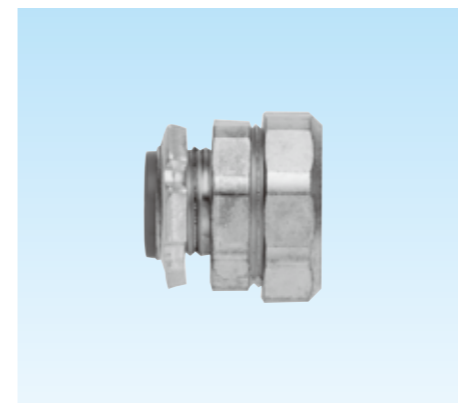

Contact us for information of product availability and delivery

KB SERIES FITTING FOR KNOCKOUT

MAIN MATERIAL	SURFACE FINISH	FEATURE	ENVIRONMENT	TEMPERATURE RANGE
ZDC2	Electroplated zinc	Non-water resistance	RoHS	Lowest - 20 °C ~Highest 100°C

SCREW THREAD FOR RIGID METAL CONDUIT AND FITTING - EXTERNAL THREAD

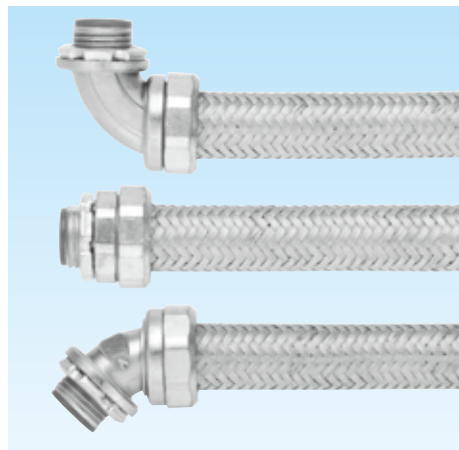

- Connector
- Connectable KEIFLEX: Refer to the chart
- Style Availability: Straight / 45 degree angle-style / 90 degree angle-style
- Designed for knockout of wiring box
- Tensile Strength Classification between Connectable KEIFLEX and Connector
Connector nominal size 10 : 500N (Medium by JIS)
Connector nominal size 12 to 54 : 1000N (Heavy by JIS)
Connector nominal size 70 or bigger: 2500N (Very Heavy by JIS)

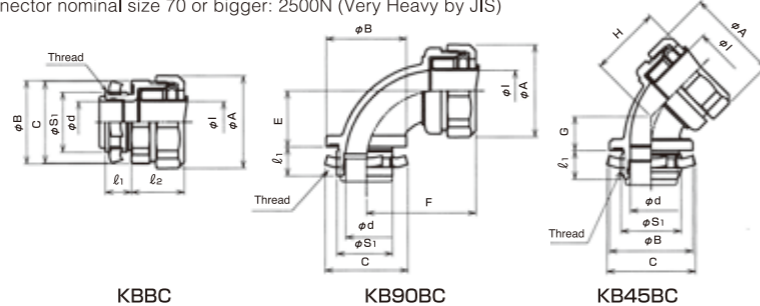

Deliv-ery	Item number	Connctable KEIFLEX	Cable max outside diameter to be inserted	φA	φB C	φd φI	l ₁	l ₂	Thread JIS C 8305		Weight (g/pc)	Qty / Package
									φS ₁	Nominal size		
○	KBBC 10	10	8	26.4	28.7	8.5	10.0	17	19.1	CTC19	50	20
○	KBBC 12	12	10	29.2	26.3	10.8	10.0	18	19.1	CTC19	60	20
○	KBBC 16	16	12	32.9	28.9	13.1	10.0	18	19.1	CTC19	65	20
○	KBBC 22	KMB	22	40.1	35.7	19.3	12.0	20	25.4	CTC25	100	20
○	KBBC 28	KIB	28	48.1	43.1	24.6	14.0	22	31.8	CTC31	150	10
○	KBBC 36	(LIB)	36	58.6	53.1	30.8	14.0	24	38.1	CTC39	210	10
○	KBBC 42		42	66.3	65.0	38.2	16.0	28	50.8	CTC51	310	10
○	KBBC 54		54	80.0	79.0	49.5	16.0	27	63.5	CTC63	430	5
⊠	KBBC 70		70	92.4	93.0	60.6	16.0	35	76.2	CTC75	1110	2



Deliv-ery	Item number	Connctable KEIFLEX	Cable max outside diameter to be inserted	φA	φB C	φd φI	E	F	l ₁	Thread JIS C 8305		Weight (g/pc)	Qty / Package
										φS ₁	Nominal size		
○	KB90BC 10	10	8	26.4	26.5	8.5	16.2	30	10	19.1	CTC19	70	20
○	KB90BC 12	12	10	29.2	27.5	10.8	18.6	33	10	19.1	CTC19	74	20
○	KB90BC 16	16	12	32.9	29.0	12.8	19.5	35	10	19.1	CTC19	88	20
○	KB90BC 22	KMB	22	40.1	35.5	19.3	24.5	41	12	25.4	CTC25	132	10
○	KB90BC 28	KIB	28	48.1	42.5	24.6	28.5	47	14	31.8	CTC31	201	10
○	KB90BC 36	(LIB)	36	58.6	50.0	30.8	31.1	53	14	38.1	CTC39	307	5
○	KB90BC 42		42	66.3	65.0	38.2	40.6	59	16	50.8	CTC51	610	5
○	KB90BC 54		54	80.0	79.0	49.5	48.0	68	16	63.5	CTC63	890	2
⊠	KB90BC 70		70	92.4	93.0	60.6	58.0	80	31	76.2	CTC75	1120	2



Deliv-ery	Item number	Connctable KEIFLEX	Cable max outside diameter to be inserted	φA	φB C	φd φI	G	H	l ₁	Thread JIS B 8305		Weight (g/pc)	Qty / Package
										φS ₁	Nominal size		
○	KB45BC 10	10	8	26.4	26.5	8.5	6.9	24	10	19.1	CTC19	70	20
○	KB45BC 12	12	10	29.2	27.5	10.8	8.6	28	10	19.1	CTC19	80	5
○	KB45BC 16	16	12	32.9	29.0	13.1	11.9	24	10	19.1	CTC19	95	20
○	KB45BC 22	KMB	22	40.1	35.5	19.3	12.4	26	12	25.4	CTC25	140	10
○	KB45BC 28	KIB	28	48.1	42.5	24.6	14.5	30	14	31.8	CTC31	250	10
○	KB45BC 36	(LIB)	36	58.6	50.0	30.8	18.6	35	14	38.1	CTC39	340	5
○	KB45BC 42		42	66.3	65.0	38.2	21.7	39	16	50.8	CTC51	500	5
○	KB45BC 54		54	80.0	79.0	49.5	25.0	44	16	63.5	CTC63	680	2
⊠	KB45BC 70		70	92.4	93.0	60.6	23.1	56	31	76.2	CTC75	1580	1

KB SERIES COUPLING FOR RIGID STEEL CONDUIT

MAIN MATERIAL	SURFACE FINISH	FEATURE	ENVIRONMENT	TEMPERATURE RANGE
ZDC2	Electroplated zinc	Non-water resistance	RoHS	Lowest - 50 °C ~Highest 150°C

KEIFLEX + RIGID STEEL CONDUIT WITH THREAD

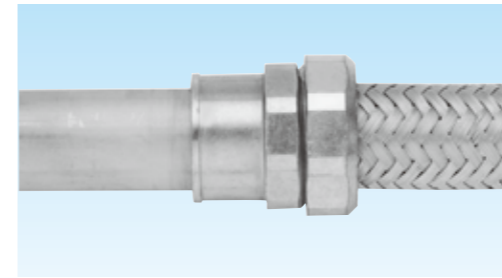

- Straight combination coupling
- Connectable KEIFLEX: Refer to the chart
- Designed to connect KEIFLEX to Rigid steel conduit with thread
- Tensile Strength Classification between Connectable KEIFLEX and combination coupling
Combination coupling nominal size 10 : 500N (Medium by JIS)
Combination coupling nominal size 12 to 54 : 1000N (Heavy by JIS)
Combination coupling nominal size 70 or bigger: 2500N (Very Heavy by JIS)

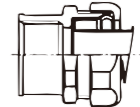

RIGID STEEL CONDUIT WITH THREAD



[RIGID STEEL CONDUIT WITH THREAD]

Deliv-ery	Item number	Connectable conduit		Cable max outside diameter to be inserted	Weight (g/pc)	Qty / Package
		KEIFLEX	RIGID STEEL CONDUIT WITH THREAD			
○	KBKG 10	10	G16 G 1/2	8	45	20
○	KBKG 12	12	G16 G 1/2	10	50	20
○	KBKG 16	16	G16 G 1/2	13	50	20
○	KBKG 22	22	G22 G 3/4	18	60	20
○	KBKG 28	MKB	G28 G 1	24	130	10
○	KBKG 36	KIB	G36 G 1-1/4	34	140	10
○	KBKG 42	(LIB)	G42 G 1-1/2	37	280	10
○	KBKG 54		G54 G2	49	290	5
○	KBKG 70		G70 G2-1/2	60	1120	2
⊠	KBKG 82		G82 G3	75	870	2
—	KBKG 92		G92 G3-1/2	85	1840	1
⊠	KBKG 104		G104 G4	98	2310	1

RIGID STEEL CONDUIT WITH THREAD



[RIGID STEEL CONDUIT WITH THREAD]

Deliv-ery	Item number	Connectable conduit			Cable max outside diameter to be inserted	Weight (g/pc)	Qty / Package
		KEIFLEX	RIGID STEEL CONDUIT WITH THREAD	Nominal size			
○	KBKC 10	10	C19 CTC19	8	42	5	
○	KBKC 12	12	C19 CTC19	10	49	5	
○	KBKC 16	16	C19 CTC19	13	55	20	
○	KBKC 22	KMB	C25 CTC25	18	85	20	
○	KBKC 28	KIB	C31 CTC31	24	130	10	
○	KBKC 36	(LIB)	C39 CTC39	32	190	10	
○	KBKC 42		C42 CTC51	37	260	5	
○	KBKC 54		C54 CTC63	48	370	5	
⊠	KBKC 70		C75 CTC75	59	1080	2	

KW SERIES FITTING

CONSTRUCTION

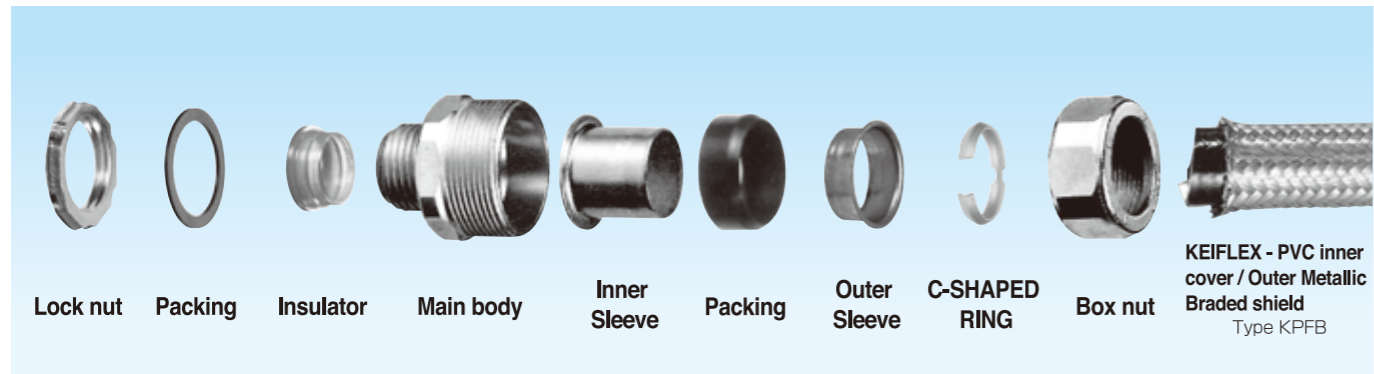

CONNECTABLE KEIFLEX

CONNECTABLE KEIFLEX	
KPFB	See NOTE a

NOTE a: Contact us for INSTALLATION INSTRUCTION

INSULATOR COLOR / THREAD

INSULATOR COLOR	THREAD
RED	G

MATERIALS

Material information is as below unless otherwise specified

PART NAME	MATERIAL	FINISH
MAIN STRAIGHT BODY	ZDC	ELECTROPLATED ZINC
90/45 DEGREE ANGLE	ZDC	ELECTROPLATED ZINC
INSULATOR	PA	-
BOX NUT	ZDC	ELECTROPLATED ZINC
INNER SLEEVE	SPCE	ELECTROPLATED ZINC
PACKING	NBR	-
OUTER SLEEVE	SPCE	ELECTROPLATED ZINC
PACKING	NBR	-
LOCK NUT	SPHC	ELECTROPLATED ZINC
C-SHAPED RING	SUS 304	-

EARTH BONDING

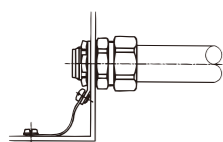

- Use WASHER WITH EARTH TERMINAL (Type RWEG) / LOCK-NUT WITH EARTH TERMINAL (RLEG) in order to complete earth bonding in good condition when KPFB is used.
- Refer to the page for the category of SANPARTS for more information.

TO CUT KEIFLEX

- KEIFLEX can be cut off by using Cutting machine or Hacksaw
- A metal saw (KFTL202) for Cutting machine is available

adhesive tape 100mm away from the area to be cut off

adhesive tape at the area to be cut off

adhesive tape 100mm away from the area to be cut off

adhesive tape 100mm away from the area to be cut off

GOOD

adhesive tape 100mm away from the area to be cut off

- Take the following action in order to prevent the components of KEIFLEX type LIGB from separating out

- Fasten adhesive tape twice around an area to be cut off
- Fasten adhesive tape tightly twice around both sides 100mm away from the area of 1)
- Cut off the center of the area of 1).

- Remove all metal burrs, Glass fiber burrs from the cut end of KEIFLEX by using a pair of scissors

- Note: After LIGB is cut off, the edge of metal conduit core and Metallic Braided shield shall have an even surface to prevent the degree of the tensile strength between a fitting and LIGB from substantially decreasing. Therefore, before LIGB is cut off, make sure to fasten adhesive tape tightly twice around both sides 100mm away from the area to be cut off in order to prevent metal conduit core, metallic braided shield from sliding to the wrong position.

KW SERIES FITTING FOR KNOCKOUT

PARALLEL PIPE THREAD - EXTERNAL THREAD

MAIN MATERIAL	SURFACE FINISH	FEATURE	ENVIRONMENT	TEMPERATURE RANGE
ZDC2	Electroplated zinc	IP67	RoHS	Lowest -20 °C ~ Highest 90°C

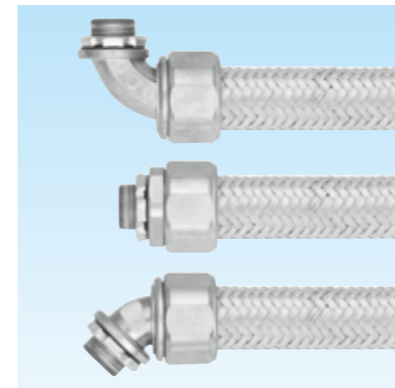

- Connector
- Connectable KEIFLEX: Refer to the chart
- Style Availability: Straight / 45 degree angle-style / 90 degree angle-style
- Designed for Knockout of Wiring box
- Tensile Strength Classification between Connectable KEIFLEX and Connector
- Connector nominal size 10 : 500N (Medium by JIS)
- Connector nominal size 12 to 54 : 1000N (Heavy by JIS)

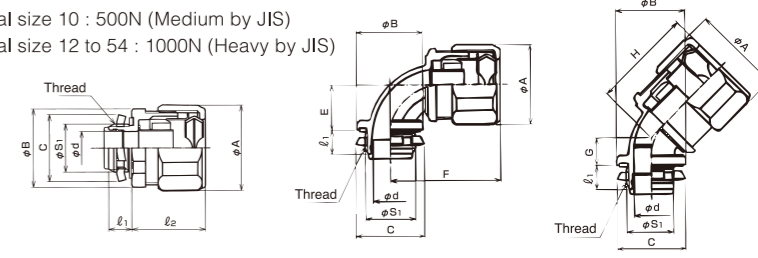

Delivery	Item number	Connectable KEIFLEX	Cable max outside diameter to be inserted	Φ A	Φ B C	Φ d	l ₁	l ₂	Thread JIS B 0202		Weight (g/pc)	Qty / Package	
									Φ S ₁	Nominal size			
☉	KWBG 10	KPFB	10	8	30.5	29.2	8.8	10	26	20.9	G 1/2	66	10
☉	KWBG 12		12	10	33.4	30.8	11.1	10	27	20.9	G 1/2	75	10
☉	KWBG 16		16	13	37.2	33.8	14.1	10	26	20.9	G 1/2	85	10
☉	KWBG 22		22	18	45.1	41.1	19.3	12	29	26.4	G 3/4	120	10
☉	KWBG 28		28	24	53.3	49.2	24.6	14	33	33.2	G 1	200	5
☉	KWBG 36		36	32	64.6	60.1	33.0	14	37	41.9	G 1-1/4	290	5
☉	KWBG 42		42	37	71.1	66.2	37.9	16	43	47.8	G 1-1/2	450	5
☉	KWBG 54		54	48	84.3	79.1	49.2	16	44	59.6	G 2	580	2

Delivery	Item number	Connectable KEIFLEX	Cable max outside diameter to be inserted	Φ A	Φ B C	Φ d	E	F	l ₁	Thread JIS B 0202		Weight (g/pc)	Qty / Package	
										Φ S ₁	Nominal size			
☉	KW90BG 10	KPFB	10	8	30.5	29.0	8.8	16.2	39	10.0	20.9	G 1/2	130	5
☉	KW90BG 12		12	10	33.4	29.0	11.1	18.6	40	10.0	20.9	G 1/2	140	5
☉	KW90BG 16		16	13	37.2	29.0	13.8	19.5	42	10.0	20.9	G 1/2	170	5
☉	KW90BG 22		22	18	45.1	36.0	19.3	24.5	48	12.0	26.4	G 3/4	195	10

Delivery	Item number	Connectable KEIFLEX	Cable max outside diameter to be inserted	Φ A	Φ B C	Φ d	G	H	l ₁	Thread JIS B 0202		Weight (g/pc)	Qty / Package	
										Φ S ₁	Nominal size			
☉	KW45BG 10	KPFB	10	8	30.5	29.0	8.8	6.9	32	10.0	20.9	G 1/2	110	5
☉	KW45BG 12		12	10	33.4	29.0	11.1	8.5	34	10.0	20.9	G 1/2	120	5
☉	KW45BG 16		16	13	37.2	29.0	14.1	11.5	30	10.0	20.9	G 1/2	150	5
☉	KW45BG 22		22	18	45.1	36.0	19.3	12.7	34	12.0	26.4	G 3/4	210	5

KW SERIES COUPLING FOR RIGID STEEL CONDUIT

MAIN MATERIAL	SURFACE FINISH	FEATURE	ENVIRONMENT	TEMPERATURE RANGE
ZDC2	Electroplated zinc	IP67	RoHS	Lowest -20 °C ~ Highest 90°C

KEIFLEX + RIGID STEEL CONDUIT WITH THREAD

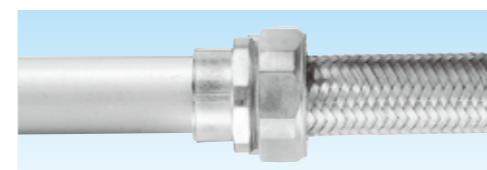

- Straight combination coupling
- Connectable KEIFLEX: Refer to the chart
- Designed to connect KEIFLEX to Rigid steel conduit with thread
- Tensile Strength Classification between Connectable

- KEIFLEX and combination coupling
- Combination coupling nominal size 10 : 500N (Medium by JIS)
- Combination coupling nominal size 12 to 54 : 1000N (Heavy by JIS)

(RIGID STEEL CONDUIT WITH THREAD)

Delivery	Item number	Connectable KEIFLEX	RIGID STEEL CONDUIT WITH THREAD		Cable max outside diameter to be inserted	Weight (g/pc)	Qty / Package
			size	Nominal size			
☉	KWKG 10	KPFB	10	G16	G 1/2	8	-
☉	KWKG 12		12	G16	G 1/2	10	90
☉	KWKG 16		16	G16	G 1/2	13	91
☉	KWKG 22		22	G22	G 3/4	18	134



KG SERIES FITTING

CONSTRUCTION

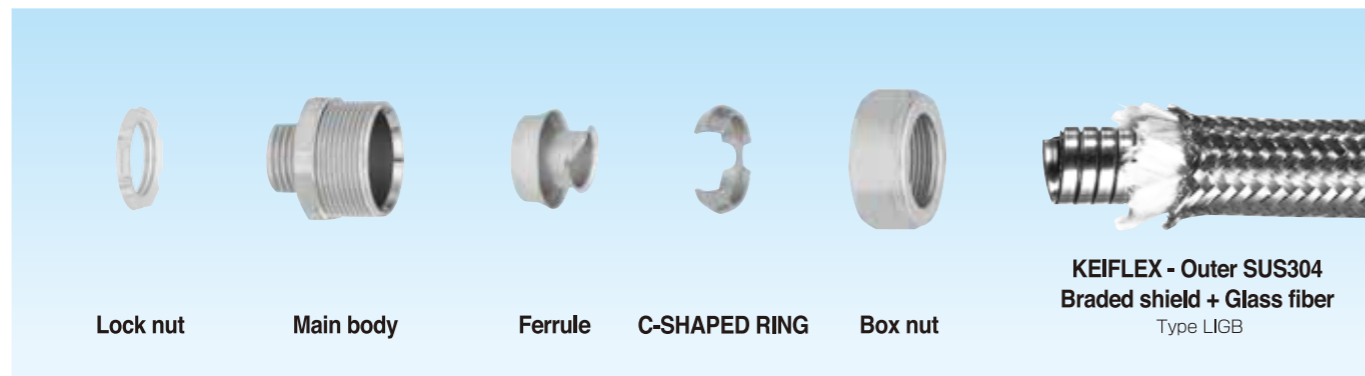

**KEIFLEX - Outer SUS304
Braided shield + Glass fiber
Type LIGB**

CONNECTABLE KEIFLEX

CONNECTABLE KEIFLEX	
LIGB	See NOTE a

NOTE a: STAINLESS FITTING is a more suitable choice

TO CUT KEIFLEX

- KEIFLEX can be cut off by using Cutting machine or Hacksaw
- A metal saw (KFTL202) for Cutting machine is available

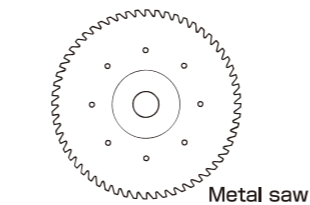

- Fasten adhesive tape twice around an area to be cut off
 - Fasten adhesive tape tightly twice around both sides 100mm away from the area of 1)
 - Cut off the center of the area of 1).
- Remove all metal burrs, Glass fiber burrs from the cut end of KEIFLEX by using a pair of scissors

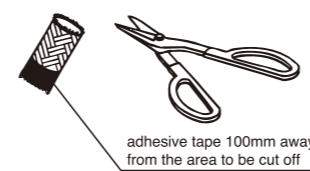
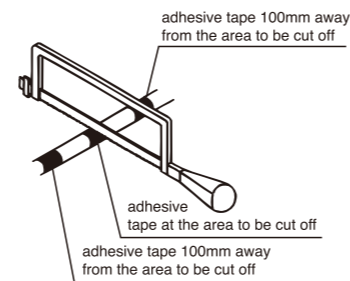

Note: After LIGB is cut off, the edge of metal conduit core and Metallic Braided shield shall have an even surface to prevent the degree of the tensile strength between a fitting and LIGB from substantially decreasing. Therefore, before LIGB is cut off, make sure to fasten adhesive tape tightly twice around both sides 100mm away from the area to be cut off in order to prevent metal conduit core, metallic braided shield from sliding to the wrong position.

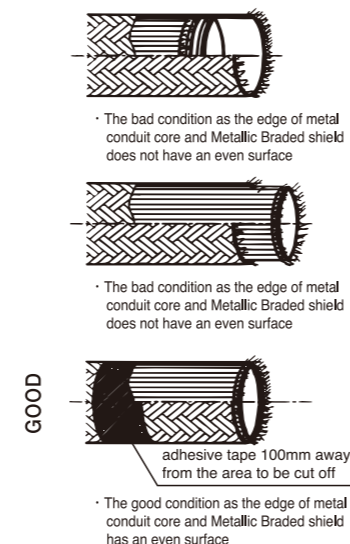

MATERIALS

Material information is as below unless otherwise specified

PART NAME	MATERIAL	FINISH	
MAIN BODY	STRAIGHT	ZDC	ELECTROPLATED ZINC
	90 DEGREE ANGLE	FCD	DACROTIZED TREATMENT
BOX NUT		ZDC	ELECTROPLATED ZINC
FERRULE		SPCE	ELECTROPLATED ZINC
C-SHAPED RING		SUS304	-
LOCK NUT		SPHC	ELECTROPLATED ZINC

STAINLESS STEEL

- SUS304 FITTING KG※L SERIES is also available
- Look at the page for the category of SANPIPE for more information

KG SERIES FITTING FOR KNOCKOUT

FEATURE	TEMPERATURE RANGE
	Lowest - 50 °C ~ Highest 150 °C

PARALLEL PIPE THREAD - EXTERNAL THREAD

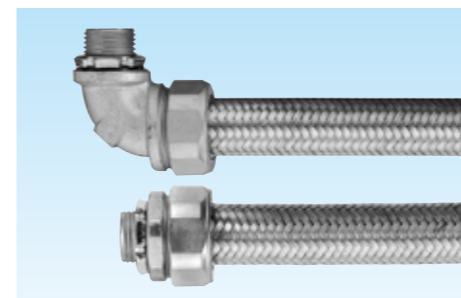

- Connector
- Connectable KEIFLEX: Refer to the chart
- Style Availability: Straight / 90 degree angle-style
- Designed for Knockout of Wiring box
- Tensile Strength Classification between Connectable KEIFLEX and Connector 1000N (Heavy by JIS)

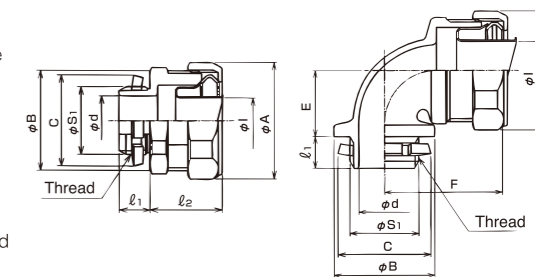

MAIN MATERIAL	SURFACE FINISH	ENVIRONMENT
ZDC2	Electroplated zinc	RoHS



MAIN MATERIAL	SURFACE FINISH
FCD	Dacrotized



Deliv-ery	Item number	Connctable KEIFLEX	Cable max outside diameter to be inserted	phi A	phi B C	phi d phi l	l1	l2	Thread		Weight (g/pc)	Qty / Package
									JIS B 0202 phi S1	Nominal size		
○	KGBG 16	13	13	37.2	33.8	14.3	10.0	26	20.9	G1/2	90	20
○	KGBG 22	18	18	45.1	41.1	19.2	12.0	27	26.4	G3/4	140	20
○	KGBG 28	24	24	53.3	49.2	24.8	14.0	32	33.2	G1	210	10
○	KGBG 36	32	32	64.6	60.1	33.2	16.0	36	41.9	G1-1/4	330	10
⑤	KGBG 42	37	37	71.1	66.2	38.2	16.0	39	47.8	G1-1/2	400	2
⑤	KGBG 54	48	48	84.3	79.1	49.5	18.0	42	59.6	G2	560	2

Deliv-ery	Item number	Connctable KEIFLEX	Cable max outside diameter to be inserted	phi A	phi B C	phi d phi l	E	F	l1	Thread		Weight (g/pc)	Qty / Package
										JIS B 0202 phi S1	Nominal size		
⑤	KG90BG 16	16	13	37.2	29.0	14.3	22.0	41	15.5	20.9	G1/2	190	20
⑤	KG90BG 22	22	18	45.1	36.0	19.3	25.5	45	15.5	26.4	G3/4	260	20
⑤	KG90BG 28	28	24	53.3	44.0	24.9	29.5	54	16.0	33.2	G1	400	10
⑤	KG90BG 36	36	32	64.6	53.0	33.3	36.0	63	18.0	41.9	G1-1/4	620	5
⑤	KG90BG 42	42	37	71.1	61.0	38.2	39.5	70	18.0	47.8	G1-1/2	780	2
⑤	KG90BG 54	54	48	84.3	75.0	49.5	45.5	78	20.0	59.6	G2	1200	2

KG SERIES COUPLING FOR RIGID STEEL CONDUIT

MAIN MATERIAL	SURFACE FINISH	FEATURE	ENVIRONMENT	TEMPERATURE RANGE
				ZDC2

KEIFLEX + RIGID STEEL CONDUIT WITH THREAD

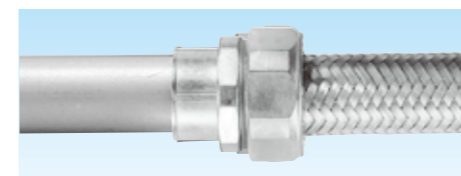

- Straight combination coupling
- Connectable KEIFLEX: Refer to the chart
- Designed to connect KEIFLEX to Rigid steel conduit with thread
- Tensile Strength Classification between Connectable KEIFLEX and combination coupling 1000N (Heavy by JIS)

RIGID STEEL CONDUIT WITH THREAD

Deliv-ery	Item number	Connctable KEIFLEX	RIGID STEEL CONDUIT WITH THREAD size		Cable max outside diameter to be inserted	Weight (g/pc)	Qty / Package
			KEIFLEX	Nominal size			
⑦	KGKG 16	16	G16	G 1/2	13	98	20
⑦	KGKG 22	22	G22	G 3/4	18	142	10
⑦	KGKG 28	28	G28	G 1	23	217	10
⑦	KGKG 36	36	G36	G 1-1/4	32	323	5
⑦	KGKG 42	42	G42	G 1-1/2	37	359	5
⑦	KGKG 54	54	G54	G 2	48	518	2

FERRULE

METAL FERRULE FOR END OF KEIFLEX

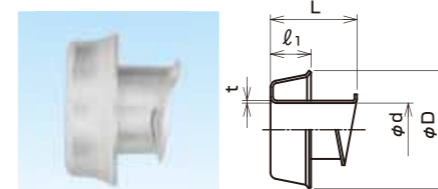

- Metal Ferrule for conduit
- Designed for KEIFLEX
- Protect cables against damage at the end of KEIFLEX

MATERIAL	SURFACE FINISH	ENVIRONMENT	TEMPERATURE RANGE
Steel	Electroplated zinc	RoHS	Lowest - 50 °C ~ Highest 200 °C

Deliv-ery	Item number	Connctable KEIFLEX	phi D	phi d	L	l1	t	Weight (g/pc)	Qty / Package
○	K(F3L) 16	16	26.3	14.3	19.1	8.8	0.5	6	10
○	K(F3L) 22	22	32.6	19.3	20.5	9.5	0.5	8	10
○	K(F3L) 28	28	40.2	24.9	22.0	10.6	0.5	12	10
○	K(F3L) 36	36	49.7	34.5	23.0	11.6	0.5	15	10
○	K(F3L) 42	42	56.0	38.2	25.1	13.0	0.6	25	10
○	K(F3L) 54	54	67.3	49.5	26.1	14.0	0.6	33	10

STAINLESS STEEL

Refer to the page for SANPIPE for information of STAINLESS STEEL FITTING / STAINLESS STEEL COMBINATION COUPLING FOR STAINLESS KEIFLEX

KC SERIES COUPLING FOR RIGID STEEL CONDUIT

MAIN MATERIAL	SURFACE FINISH	FEATURE	ENVIRONMENT	KC3 SERIES TEMPERATURE RANGE	KC SERIES TEMPERATURE RANGE
ZDC2	Electroplated zinc	Non-water resistance	RoHS	Lowest -20 °C ~Highest 90°C	Lowest -20 °C ~Highest 100°C

SCREW-IN TYPE

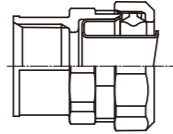
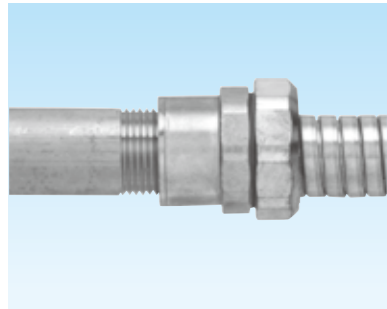

- Straight combination coupling
- Connectable KEIFLEX: Refer to the chart
- Designed to connect KEIFLEX to Rigid steel conduit with thread
- Connection between KEIFLEX and Combination coupling: Union Type
- Connection between Rigid steel Conduit with thread and Combination coupling : Screw-in type
- Tensile Strength Classification between Connectable KEIFLEX and combination coupling
 Combination coupling nominal size 10 : 500N (Medium by JIS)
 Combination coupling nominal size 12 to 54 : 1000N (Heavy by JIS)
- For better heat resistance and tensile strength, choose type KCKG / KCKC instead of type KC3KG / KC3KC

[RIGID STEEL CONDUIT WITH THREAD]

Delivery	Item number	Connectable conduit			Cable max outside diameter to be inserted	Weight (g/pc)	Qty / Package
		KEIFLEX	NON-THREAD RIGID STEEL CONDUIT size	Nominal size			
③	KC3KG 10	10	G16	G1/2	8	47	20
③	KC3KG 12	12	G16	G1/2	10	55	20
③	KC3KG 16	16	G16	G1/2	13	60	20
③	KC3KG 22	22	G22	G3/4	18	90	20
③	KC3KG 28	28	G28	G1	24	140	10
③	KC3KG 36	36	G36	G1-1/4	34	200	10
③	KC3KG 42	42	G42	G1-1/2	37	280	10
③	KC3KG 54	54	G54	G2	49	380	5

[RIGID STEEL CONDUIT WITH THREAD]

Delivery	Item number	Connectable conduit			Cable max outside diameter to be inserted	Weight (g/pc)	Qty / Package
		KEIFLEX	NON-THREAD RIGID STEEL CONDUIT size	Nominal size			
③	KC3KC 10	10	C19	CTC19	8	43	10
③	KC3KC 12	12	C19	CTC19	10	50	10
③	KC3KC 16	16	C19	CTC19	13	55	20
③	KC3KC 22	22	C25	CTC25	18	85	10
③	KC3KC 28	28	C31	CTC31	24	130	5
③	KC3KC 36	36	C39	CTC39	34	190	5
③	KC3KC 42	42	C51	CTC51	37	270	2
③	KC3KC 54	54	C63	CTC63	49	370	2

KEIFLEX + NON-THREAD RIGID STEEL CONDUIT/NON-THREADABLE RIGID STEEL CONDUIT

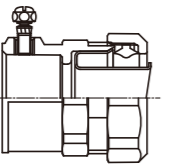
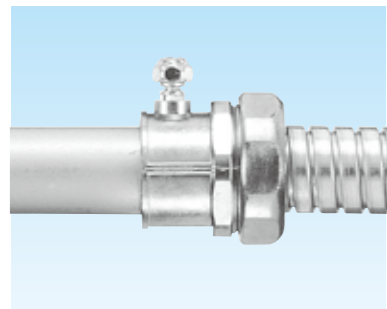

- Straight combination coupling
- Connectable KEIFLEX: Refer to the chart
- Designed to connect KEIFLEX to Non-thread rigid steel conduit / Non-threadable rigid steel conduit
- Note: Rigid steel conduit with thread shall NOT be used
- Connection between KEIFLEX (KM/KI) and Combination coupling: Union Type
- Connection between Non-thread rigid steel conduit / Non-threadable rigid steel conduit and Combination coupling : screw-fixed type
- Tensile Strength Classification between connectable KEIFLEX and Combination coupling
 Combination coupling nominal size 10 : 500N (Medium by JIS)
 Combination coupling nominal size 12 to 54 : 1000N (Heavy by JIS)
- Tensile Strength Classification between connectable Non-thread rigid steel conduit / Non-threadable rigid steel conduit and Combination coupling
 Combination coupling nominal size 10 to 28 : 500N (Medium by JIS)
 Combination coupling nominal size 36 or bigger size : 1000N (Heavy by JIS)
- For better heat resistance and tensile strength, choose type KCKI / KCKE instead of type KC3KI / KC3KE

[NON-THREAD RIGID STEEL CONDUIT]

Delivery	Item number	Connectable conduit			Cable max outside diameter to be inserted	Weight (g/pc)	Qty / Package
		KEIFLEX	NON-THREAD RIGID STEEL CONDUIT	Nominal size			
—	KC3KI 10	10	G16		8	50	10
—	KC3KI 12	12	G16		10	55	10
③	KC3KI 16	16	G16		13	65	20
③	KC3KI 22	22	G22		18	95	10
③	KC3KI 28	28	G28		24	130	10
③	KC3KI 36	36	G36		34	200	10
③	KC3KI 42	42	G42		37	280	10
③	KC3KI 54	54	G54		49	360	5

[NON-THREAD RIGID STEEL CONDUIT/NON-THREADABLE RIGID STEEL CONDUIT]

Delivery	Item number	Connectable conduit			Cable max outside diameter to be inserted	Weight (g/pc)	Qty / Package
		KEIFLEX	NON-THREADABLE RIGID STEEL CONDUIT/ NON-THREAD RIGID STEEL CONDUIT	Nominal size			
③	KC3KE 10	10	E19/C19		8	50	20
③	KC3KE 12	12	E19/C19		10	55	20
③	KC3KE 16	16	E19/C19		13	65	20
③	KC3KE 22	22	E25/C25		18	95	20
③	KC3KE 28	28	E31/C31		24	140	10
③	KC3KE 36	36	E39/C39		34	200	10
③	KC3KE 42	42	E51/C51		37	290	10
③	KC3KE 54	54	E63/C63		49	390	5

KEIFLEX

SANLEKI
ROBO

KEIGLAND

POWER
GODZILLA

PLICA TUBE

SANPIPE

GRIPLOK

SANPARTS

SANCABLE

SANCUBE